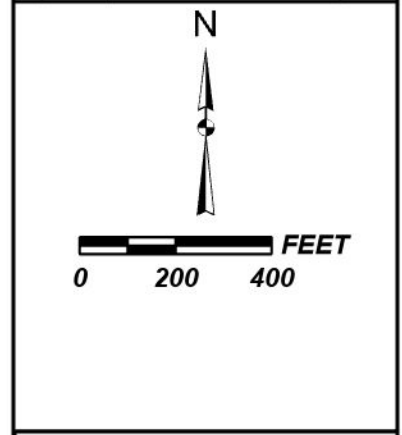
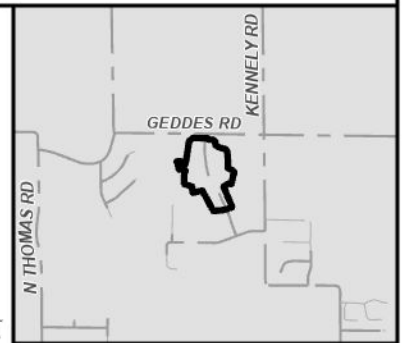
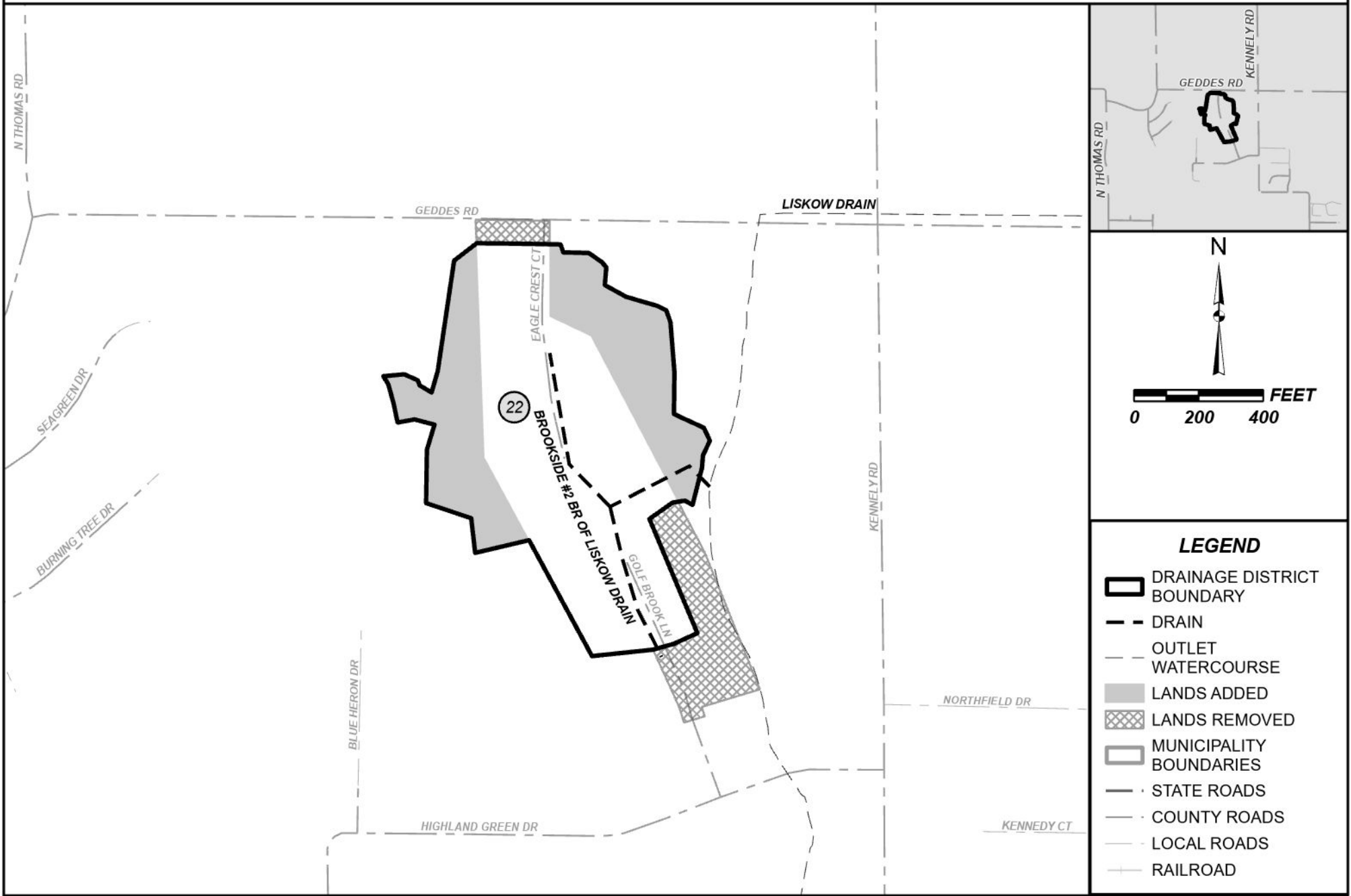

EXHIBIT "B1"
BROOKSIDE #2 BRANCH OF LISKOW DRAIN DRAINAGE DISTRICT
 SAGINAW COUNTY PUBLIC WORKS COMMISSIONER
 BRIAN J. WENDLING



LEGEND

	DRAINAGE DISTRICT BOUNDARY
	DRAIN
	OUTLET WATERCOURSE
	LANDS ADDED
	LANDS REMOVED
	MUNICIPALITY BOUNDARIES
	STATE ROADS
	COUNTY ROADS
	LOCAL ROADS
	RAILROAD